

FOR LEASE

Jr. Anchor Space | ±14,779 SF



1315 S. Bradley Road | Santa Maria, CA

Brian La Cabe
805.928.2800 ext. 103
BLacabe@pacificaCRE.com
Lic #01026699

Chris Garner
805.928.2800 ext. 104
CGarner@pacificaCRE.com
Lic #01010310



2520 Professional Parkway | Santa Maria, CA 93455 | PacificaSantaMaria.com

Information contained herein has been obtained from the owner of the property or from other sources deemed reliable. We have no reason to doubt its accuracy, but we do not guarantee it.

FOR LEASE 1315 S. Bradley Road, Santa Maria, CA



Listing Details

- Lease Rate: \$1.17/SF/Mo./NNN
- Estimated NNN: \$0.25/SF
- Term: Negotiable

Property Details

- Available Space: +/-14,779
- Property Type: Freeway Oriented Center
- Zoning: PD-C2(Planned Development- General Commercial)
- Gov't Authority: City of Santa Maria
- Traffic Counts (2018): Stowell Road -20,218 AADT
US 101- 68,000 AADT
- Available: Immediately

Join Trader Joe's, BevMo and Michael's in this well-located center directly across from the "Stowell Road" interchange. This freeway-oriented center has plenty of easy parking with good ingress/egress via both Stowell and South Bradley Roads. Call listing agents for showing instructions and further details.

Brian LaCabe

805.928.2800 ext. 103

BLacabe@pacificacre.com

Lic #01026699

Chris Garner

805.928.2800 ext. 104

CGarner@pacificacre.com

Lic #01010310



2520 Professional Parkway | Santa Maria, CA 93455 | PacificaSantaMaria.com

FOR LEASE 1315 S. Bradley Road, Santa Maria, CA

Site Plan

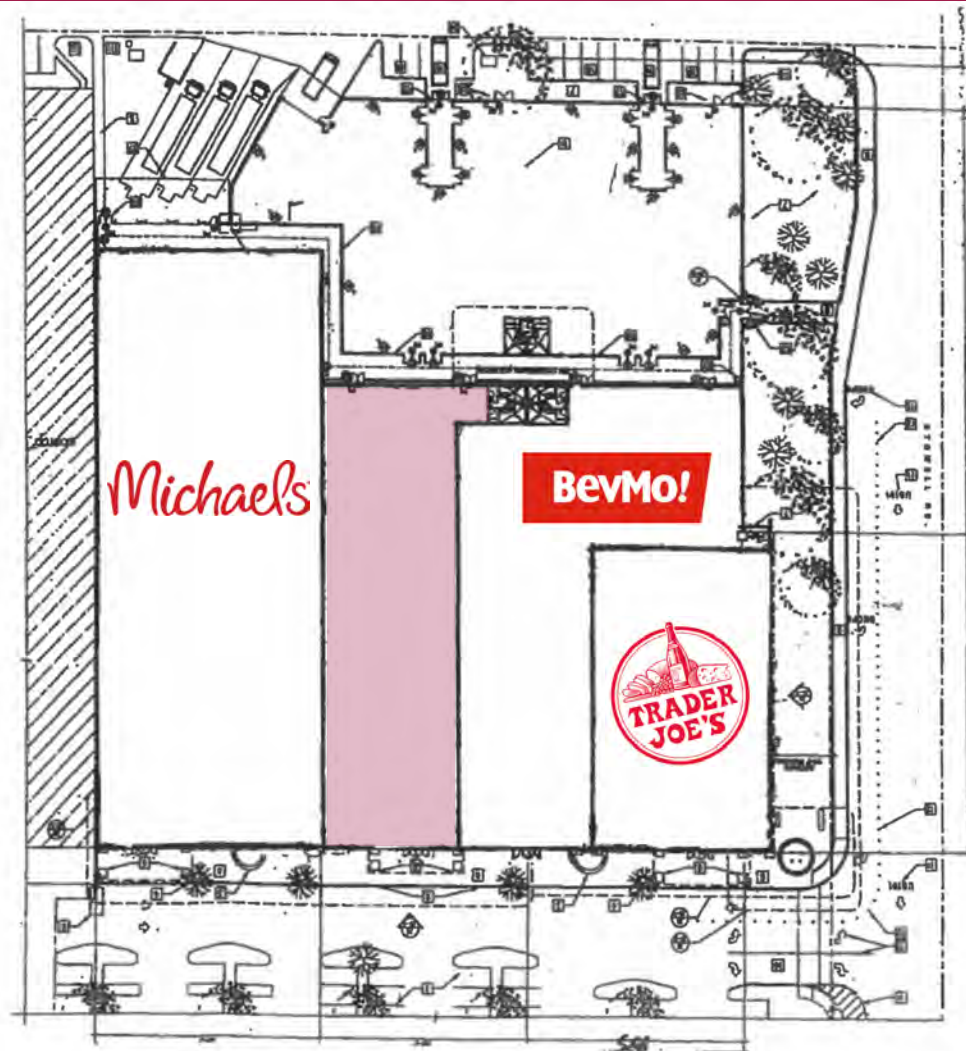

South Bradley

 Available

Brian LaCabe
805.928.2800 ext. 103
BLacabe@pacificacre.com
Lic #01026699

Chris Garner
805.928.2800 ext. 104
CGarner@pacificacre.com
Lic #01010310



2520 Professional Parkway | Santa Maria, CA 93455 | PacificaSantaMaria.com

Information contained herein has been obtained from the owner of the property or from other sources deemed reliable. We have no reason to doubt its accuracy, but we do not guarantee it.

FOR LEASE 1315 S. Bradley Road, Santa Maria, CA



Brian LaCabe
805.928.2800 ext. 103
BLacabe@pacificacre.com
Lic #01026699

Chris Garner
805.928.2800 ext. 104
CGarner@pacificacre.com
Lic #01010310



2520 Professional Parkway | Santa Maria, CA 93455 | PacificaSantaMaria.com